

# CF14 Single Manifold Assembly

01-05-009RP

CF14-14-XXX-XXX MANIFOLD ASSEMBLY  
FOR 14" CENTERS  
CF14-11-XXX-XXX MANIFOLD ASSEMBLY  
FOR 11" CENTERS

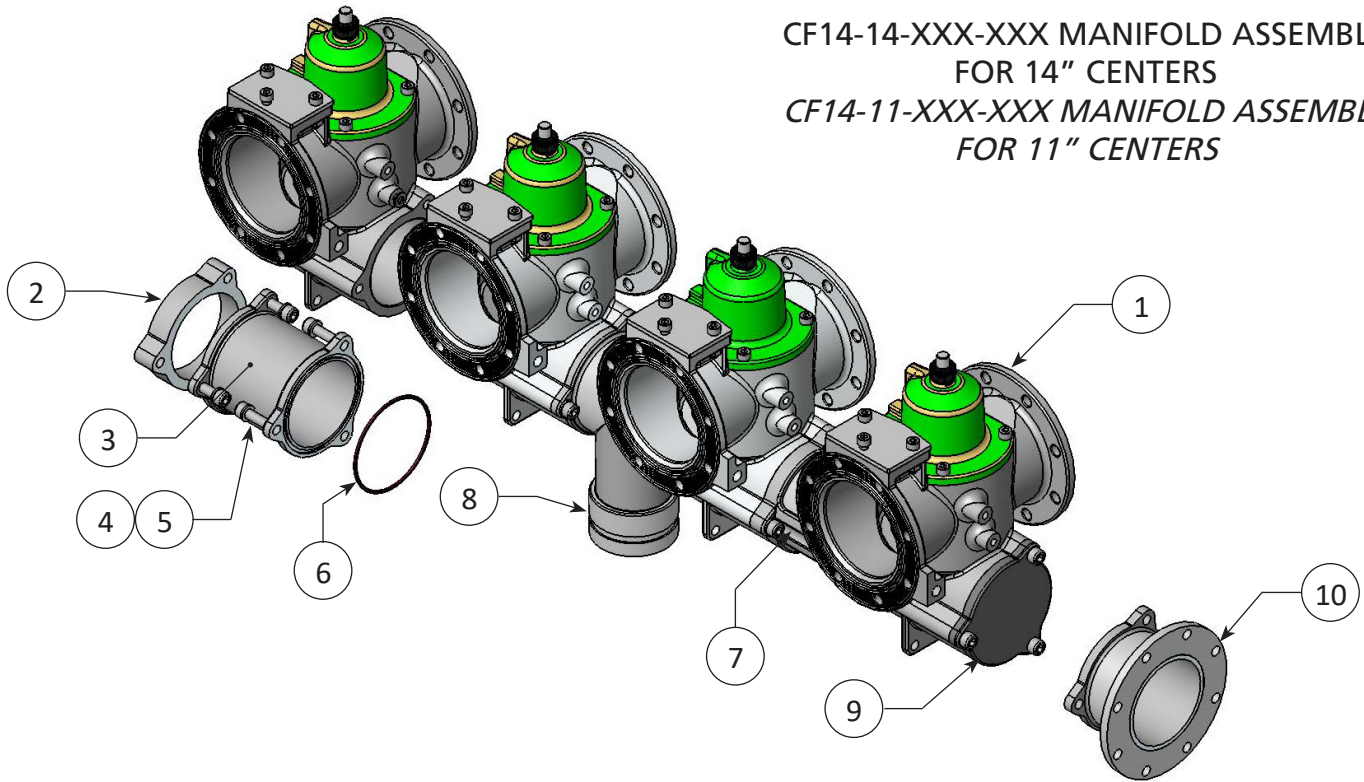

ITEM	PART NUMBER	DESCRIPTION
1	10540M	SINGLE MANIFOLD VALVE ASSEMBLY
2	10982M	SPACER, 1" WIDE FOR 12" CENTERS
3	10562M	COLLECTOR PIPE FOR 14" CENTERS, 355MM
3	10561M	COLLECTOR PIPE FOR 11" CENTERS, 280MM
4	10576M	SCREW, M10 x 35 ZINC PLATED (TYPICAL)
5	10740M	LOCK WASHER, M10 ZINC PLATED (TYPICAL)
6	10494M	O-RING, 102 x 3 NITRILE (TYPICAL)
7	10644M	COLLECTOR SIGHT GLASS FOR 14" CENTERS
7	10698M	COLLECTOR SIGHT GLASS FOR 11" CENTERS
8	10798M	COLLECTOR TEE FOR 14" CENTERS, 3" VICTAULIC
8	10697M	COLLECTOR TEE FOR 11" CENTERS, 3" VICTAULIC
9	10558M	END CAP ASSEMBLY
10	10983M	OUTLET ADAPTER, 4" TTMA (OPTIONAL)



www.civacon.com ◆ 9393 Princeton-Glendale Road ◆ Hamilton, Ohio, USA 45011 ◆ Phone: (800) 422-2525 ◆ Fax: (800) 421-3297

NOTE: All information subject to engineering and/or other changes. All trade names are copyrighted. Patents Pending. ©2018 Civacon. ©2018 Delaware Capital Formation, Inc. All Rights Reserved. DOVER and the DOVER logo are registered trademarks of Delaware Capital Formation, Inc., a wholly-owned subsidiary of Dover Corporation.

Rev B Mar 2020

DEFINING | WHAT'S NEXT