



CNG Type 2 Fueling System

The OPW CleanEnergy CNG 3-Way Valve and Type 2 Nozzle features the latest in industrial and commercial fueling innovations. A Fueling System which bridges the gap between convenience and comfort, without sacrificing flow or reliability. Ergonomically designed to be easy to use and prevent unnecessary wear and tear during the fueling process.

NT2A Series Fast-Fill/ Fleet-Fill Nozzles (NGV1 & ISO14469 Type 2 or 3)

OPW NT2A Series Fast-Fill/Fleet-Fill Nozzles are designed for high-flow CNG fueling systems. Applications include quick-fill fueling of automobiles, light trucks, shuttle buses, vans and time-fill or overnight fleet fueling.



Product #	Inlet Thread Size	Color	Service Pressure
NT2AP30	SAE - 6, 9/16" - 18 UNF	Blue	NGV1 P30 ISO14469 B200 3000 psi (200 bar)
NT2AP36	SAE - 6, 9/16" - 18 UNF	Yellow	NGV1 P36 ISO14469 G250 3600 psi (250 bar)

Materials

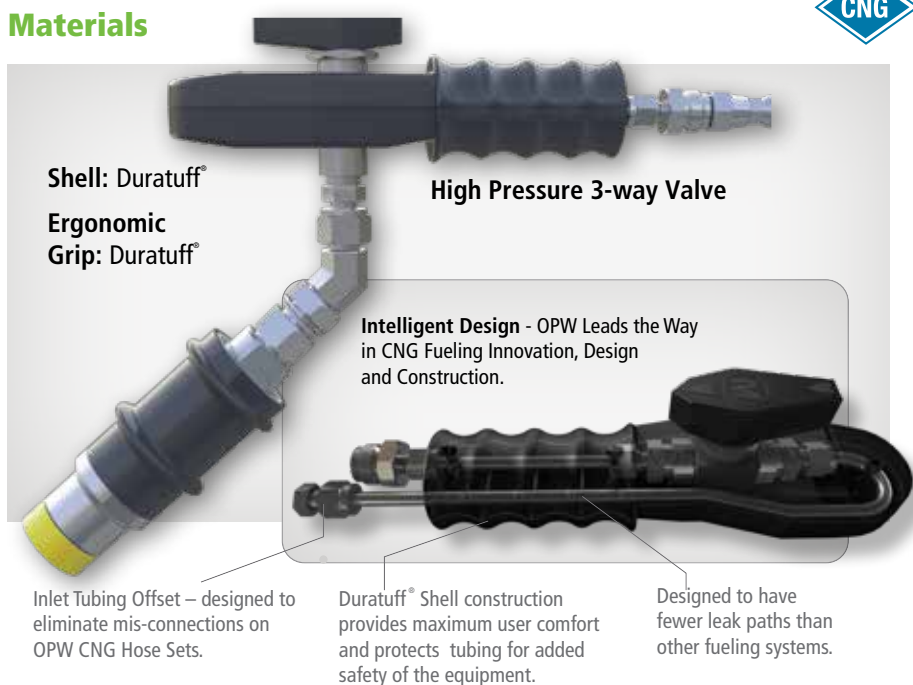

Features

- ◆ **Hose Connection Options** - Time-Fill Applications - 4/4 Sized Hose (1/4" Inlet and 1/4" Vent). Fast-Fill Applications - 4/6 Sized Hose (3/8" Inlet and 1/4" Vent)
- ◆ **Ergonomic Grip** - Duratuff® Grip provides maximum user comfort and control
- ◆ **Duratuff® Shell** - Specifically designed to handle operational wear-and-tear as well as protecting your vehicle from dents and scratches during fueling.
- ◆ **CNG Type 2 Fueling System Extension Options** - Offers the convenience of connection flexibility. Operators can connect to vehicles regardless of the application. Use one of four different connection options; 3/4", 45°, 4" Rigid or 17" Flex Hose to help in fueling difficult-to-reach receptacles or tanks.
- ◆ **NT2A Series Nozzle** - Feature a field serviceable internal filter to capture gas-borne debris commonly found in CNG Fueling systems.

Listings and Certifications



NGV1 ISO14469

NEW

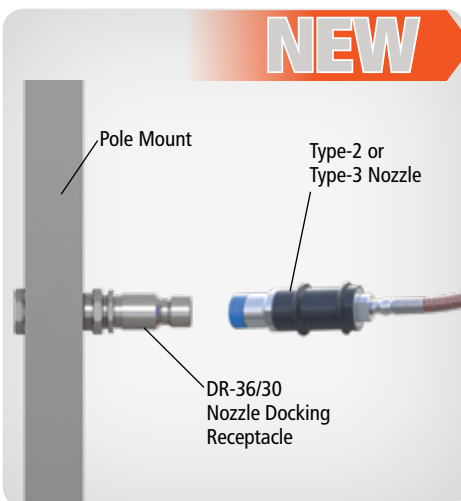

DR-36/30 Nozzle Docking Receptacle

This is a Nozzle Docking receptacle to be used ONLY for Type-2 & Type-3 nozzle mounting purposes. There are no working internals, therefore it may only be used as a docking storage device. **NOTE:** It shall not be used to dock a Type-1 nozzle.

Ordering Specifications

Product #	Description
DR-36/30	Nozzle Docking Receptacle

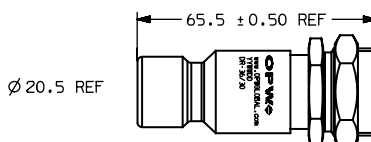

Nozzle Types

- Type 1** - Nozzle with an integrated vent valve system. This vent valve is controlled by the single lever operation which will safely vent the gas trapped between the receptacle check valve and the nozzle inlet valve. After the venting process, the nozzle will disconnect from the vehicle's receptacle.
- Type 2** - The vent valve operating mechanism is external to the nozzle. Venting is required prior to disconnection of this type of nozzle.
- Type 3** - The fueling hose is automatically depressurized below 50psi (3.4Bar) at dispenser shutdown. The nozzle will vent low pressure gas between the receptacle check valve and the nozzle inlet valve.

NOTE: This device shall not be installed on a vehicle nor be connected to a pressurized source of any type.



CNG Type 2 Fueling System

FOUR EXTENDER OPTIONS TO CHOOSE FROM

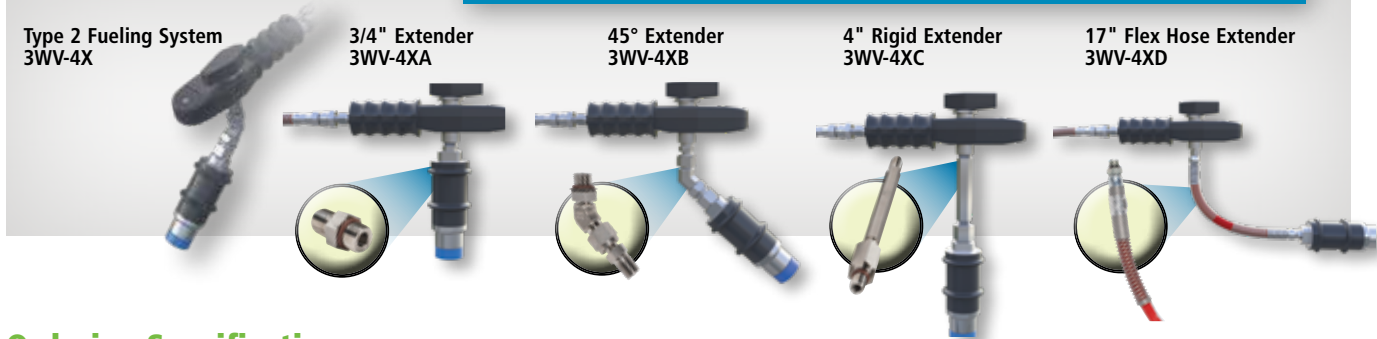

Ordering Specifications

Product #	Description	Connection		Approx. Weight	Service Pressure
		Fill	Vent		
3WV-44	3-way valve, cover and outlet tubing, connections				
3WV-44A	3-way valve, cover, outlet tubing				
3WV-44B	3-way valve, cover, outlet tubing and 45 degree extender	4- <small>SAE-AN</small>	4- <small>SAE-AN</small>	1.4 lb. (.63 kg)	up to 5,000 psi / 345 bar
3WV-44C	3-way valve, cover, outlet tubing, connections and 4" rigid extender				
3WV-44D	3-way valve, cover, outlet tubing, connections and whip-hose extender				
3WV-44AP30	3-way valve, cover, outlet tubing and 3/4" extender and NT2AP30				
3WV-44BP30	3-way valve, cover, outlet tubing and 45 degree extender and NT2AP30	4- <small>SAE-AN</small>	4- <small>SAE-AN</small>	2.74 lb. (1.24 kg)	3,000 psi / 200 bar
3WV-44CP30	3-way valve, cover, outlet tubing and 4" rigid extender and NT2AP30				
3WV-44DP30	3-way valve, cover, outlet tubing and whip-hose extender and NT2AP30				
3WV-44AP36	3-way valve, cover, outlet tubing and 3/4" extender and NT2AP36				
3WV-44BP36	3-way valve, cover, outlet tubing and 45 degree extender and NT2AP36	4- <small>SAE-AN</small>	4- <small>SAE-AN</small>	2.74 lb. (1.24 kg)	3,600 psi / 250 bar
3WV-44CP36	3-way valve, cover, outlet tubing and 4" rigid extender and NT2AP36				
3WV-44DP36	3-way valve, cover, outlet tubing and whip-hose extender and NT2AP36				
3WV-46	3-way valve, cover, outlet tubing				
3WV-46A	3-way valve, cover, outlet tubing and 3/4" extender				
3WV-46B	3-way valve, cover, outlet tubing and 45 degree extender	8- <small>SAE-AN</small>	4- <small>SAE-AN</small>	1.416 lb. (.63 kg)	up to 5,000 psi / 345 bar
3WV-46C	3-way valve, cover, outlet tubing and 4" rigid extender				
3WV-46D	3-way valve, cover, outlet tubing and whip-hose extender				
3WV-46AP30	3-way valve, cover, outlet tubing and 3/4" extender and NT2AP30				
3WV-46BP30	3-way valve, cover, outlet tubing and 45 degree extender and NT2AP30	8- <small>SAE-AN</small>	4- <small>SAE-AN</small>	2.74 lb. (1.24 kg)	3,000 psi / 200 bar
3WV-46CP30	3-way valve, cover, outlet tubing and 4" rigid extender and NT2AP30				
3WV-46DP30	3-way valve, cover, outlet tubing and whip-hose extender and NT2AP30				
3WV-46AP36	3-way valve, cover, outlet tubing and 3/4" extender and NT2AP36				
3WV-46BP36	3-way valve, cover, outlet tubing and 45 degree extender and NT2AP36	8- <small>SAE-AN</small>	4- <small>SAE-AN</small>	2.74 lb. (1.24 kg)	3,600 psi / 250 bar
3WV-46CP36	3-way valve, cover, outlet tubing and 4" rigid extender and NT2AP36				
3WV-46DP36	3-way valve, cover, outlet tubing and whip-hose extender and NT2AP36				

Canadian Registration Numbers by Province

Canadian Registration Numbers OPW CleanEnergy Products	British Columbia	Alberta	Ontario	Quebec	Saskatchewan	Manitoba	Nova Scotia	New Brunswick
NT2A series	0C21049.21	0C21049.2	0C21049.25	0C21049.26	0C21049.23	0C21049	0C21049.29	0C21049.29
CT1000 series	0H18834.21	0H18834.2	0H18834.25	0H18834.26	0H18834.23	0H18834.24	0H18834.28ADD1	0H18834.27ADD1
CT5000	0H15417.51	0H18834.2	0H15417.5	0H15417.56	0H15417.56	0H15417.54	0H15417.58ADD1	0H18834.27
CC600 series	0H18834.21	0H18834.2	0H18834.25	0H18834.26	0H18834.23	0H18834.24	0H18834.28ADD1	0H18834.27ADD1
ILB-1	0H18834.21	0H18834.2	0H18834.25	0H18834.26	0H18834.23	0H18834.24	0H18834.28ADD1	0H18834.27ADD1
ILB-5	0H15417.51	0H15417.52	0H15417.5	0H15417.56	0H15417.56	0H15417.56	Pending	Pending
VLB	0H13989.51	0H13989.52	0H13989.5	0H13989.56	0H13989.56	0H13989.56	Pending	Pending
FLB-1000	0H17341.51	0H17341.52	0H17341.5	0H17341.56	0H17341.56	0H17341.56	0H17341.5987	0H17341.5987
FLB-5000	0H17341.51	0H17341.52	0H17341.5	0H17341.56	0H17341.56	0H17341.56	0H17341.5987	0H17341.5987
NGVLB	0H17341.51	0H17341.52	0H17341.5	0H17341.56	0H17341.56	0H17341.56	0H17341.5987	0H17341.5987
BDN	Pending	0H17140.21	0H17140.25	0H17190.26	Pending	0H17140.24	Pending	Pending

TUV Approved

- ◆ NT2A series nozzles
- ◆ CT1000 series nozzles
- ◆ CT5000 series nozzles
- ◆ CC 6000 series nozzles
- ◆ ILB series breakaways
- ◆ FLB series breakaways
- ◆ NGVLB series breakaways
- ◆ LB, LD, LE series receptacles
- ◆ CL series receptacles